

HM 78 A-B

ARCHITECT OF RECORD:

S.M. BERGER ARCHITECTURE, P.C.

P.O. BOX 222113
GREAT NECK, NEW YORK 11022 TEL: 516. 773. 7365

EXECUTIVE ARCHITECT:

SLICE ARCHITECTS, LLP

1309 BROADWAY
NEW YORK, NY 10018 TEL: 212. 979. 8400

STRUCTURAL ENGINEER:

WSP CANTOR SENUK

228 EAST 43TH STREET
NEW YORK, NY 10017 TEL: 212. 687. 9888

M/E/P ENGINEER:

WSP FLACK + KURTZ

312 E 29TH AVENUE
NEW YORK, NY 10018 TEL: 212. 532. 9600

CODE CONSULTANT / EXPEDITING:

JEROME S. GILLMAN CONSULTING ARCHITECTS, P.C.

40 WORTH STREET
NEW YORK, NY 10013 TEL: 212. 349. 9304

ZONING CONSULTANT:

COMcheck Software Version 4.0.4.1 Mechanical Compliance Certificate

Project Information
Energy Code: 2014 New York Energy Conservation Construction Code
Project Title: Apartment 61B
Location: New York County, New York
Climate Zone: 4a
Project Type: Addition

Construction Site: 432 Park Ave, New York, NY 10022
Owner/Agent: Designer/Contractor:

Mechanical Systems List

Quantity	System Type & Description
1	HVAC System 1 (Single Zone). Heating: 1 each - Hydronic or Steam Coil, Hot Water, Capacity = 52 kBtu/h No minimum efficiency requirement applies Cooling: 1 each - Hydronic Coil, Capacity = 36 kBtu/h, Water Economizer No minimum efficiency requirement applies Fan System: None

Mechanical Compliance Statement
Compliance Statement: The proposed mechanical design presented in this document is consistent with the building plans, specifications, and other calculations submitted with this permit application. The proposed mechanical systems have been designed to meet the 2014 New York Energy Conservation Construction Code requirements in COMcheck Version 4.0.4.1 and to comply with any applicable mandatory requirements listed in the Inspection Checklist.

Name - Title _____ Signature _____ Date _____

Project Title: Apartment 61B Report date: 06/26/17
Data filename: P:\N10\40300-440_PARK_AVENUE_MEP\CAD\MEP TENANT DESIGN APT 78B\ENG-HVAC\61B- Page 1 of 8
20170522.cck

COMcheck Software Version 4.0.4.1 Inspection Checklist

Energy Code: 2014 New York Energy Conservation Construction Code

Requirements: 70.0% were addressed directly in the COMcheck software
Text in the "Comments/Assumptions" column is provided by the user in the COMcheck Requirements screen. For each requirement, the user certifies that a code requirement will be met and how that is documented, or that an exception is being claimed. Where compliance is itemized in a separate table, a reference to that table is provided.

Section # & Req. ID	Plan Review	Complies?	Comments/Assumptions
C103.2 [PR2]¹	Plans, specifications, and/or calculations provide all information with which compliance can be determined for the mechanical systems and equipment and document where exceptions to the standard are claimed. Load calculations per acceptable engineering standards and handbooks.	<input checked="" type="checkbox"/> Complies <input type="checkbox"/> Does Not <input type="checkbox"/> Not Observable <input type="checkbox"/> Not Applicable	Requirement will be met.
C406 [PR9]¹	Plans, specifications, and/or calculations provide all information with which compliance can be determined for the additional energy efficiency package options.	<input checked="" type="checkbox"/> Complies <input type="checkbox"/> Does Not <input type="checkbox"/> Not Observable <input type="checkbox"/> Not Applicable	

Additional Comments/Assumptions:

1 High Impact (Tier 1) 2 Medium Impact (Tier 2) 3 Low Impact (Tier 3)

Project Title: Apartment 61B Report date: 06/26/17
Data filename: P:\N10\40300-440_PARK_AVENUE_MEP\CAD\MEP TENANT DESIGN APT 78B\ENG-HVAC\61B- Page 2 of 8
20170522.cck

Section # & Req. ID	Footing / Foundation Inspection	Complies?	Comments/Assumptions
C403.2.4 [FO9]¹	Freeze protection and snow/ice melting system sensors for future connection to controls.	<input type="checkbox"/> Complies <input type="checkbox"/> Does Not <input type="checkbox"/> Not Observable <input type="checkbox"/> Not Applicable	Exception: Requirement does not apply.

Additional Comments/Assumptions:

1 High Impact (Tier 1) 2 Medium Impact (Tier 2) 3 Low Impact (Tier 3)

Project Title: Apartment 61B Report date: 06/26/17
Data filename: P:\N10\40300-440_PARK_AVENUE_MEP\CAD\MEP TENANT DESIGN APT 78B\ENG-HVAC\61B- Page 3 of 8
20170522.cck

Section # & Req. ID	Mechanical Rough-In Inspection	Complies?	Comments/Assumptions
C403.2.3 [ME53]¹	HVAC equipment efficiency verified.	<input checked="" type="checkbox"/> Complies <input type="checkbox"/> Does Not <input type="checkbox"/> Not Observable <input type="checkbox"/> Not Applicable	See the Mechanical Systems list for values.
C403.2.5 [ME59]¹	Demand control ventilation provided for spaces >500 sq.ft. and >25 people/1000 sq.ft. occupant density and served by systems with air side economizer, auto modulating outside air damper control, or design airflow >3,000 cfm.	<input type="checkbox"/> Complies <input type="checkbox"/> Does Not <input type="checkbox"/> Not Observable <input type="checkbox"/> Not Applicable	Exception: Requirement does not apply.
C403.2.7 [ME60]¹	HVAC ducts and plenums insulated. Where ducts or plenums are installed in or under a slab, verification may need to occur during Foundation inspection.	<input checked="" type="checkbox"/> Complies <input type="checkbox"/> Does Not <input type="checkbox"/> Not Observable <input type="checkbox"/> Not Applicable	Requirement will be met.
C403.2.8 [ME61]¹	HVAC piping insulation thickness. Where piping is installed in or under a slab, verification may need to occur during Foundation inspection.	<input checked="" type="checkbox"/> Complies <input type="checkbox"/> Does Not <input type="checkbox"/> Not Observable <input type="checkbox"/> Not Applicable	Requirement will be met.
C403.2.8 [ME7]¹	Piping insulation exposed to weather is protected from damage (due to sun, moisture, wind, etc.).	<input checked="" type="checkbox"/> Complies <input type="checkbox"/> Does Not <input type="checkbox"/> Not Observable <input type="checkbox"/> Not Applicable	Requirement will be met.
C403.2.8 [ME41]¹	Thermally ineffective panel surfaces of sensible heating panels have insulation >= R-3.5.	<input checked="" type="checkbox"/> Complies <input type="checkbox"/> Does Not <input type="checkbox"/> Not Observable <input type="checkbox"/> Not Applicable	Requirement will be met.
C403.2.7 [ME10]¹	Ducts and plenums sealed based on static pressure and location.	<input checked="" type="checkbox"/> Complies <input type="checkbox"/> Does Not <input type="checkbox"/> Not Observable <input type="checkbox"/> Not Applicable	Requirement will be met.
C403.2.7.1.3 [ME11]¹	Ductwork operating >3 in. water column requires air leakage testing.	<input type="checkbox"/> Complies <input type="checkbox"/> Does Not <input type="checkbox"/> Not Observable <input checked="" type="checkbox"/> Not Applicable	Exception: Requirement does not apply.
C403.4.3.1 [ME50]¹	Three-pipe hydronic systems using a common return for hot and chilled water are not used.	<input type="checkbox"/> Complies <input type="checkbox"/> Does Not <input type="checkbox"/> Not Observable <input checked="" type="checkbox"/> Not Applicable	Requirement will be met.
C408.2.2.1 [ME53]¹	Air outlets and zone terminal devices have means for air balancing.	<input checked="" type="checkbox"/> Complies <input type="checkbox"/> Does Not <input type="checkbox"/> Not Observable <input type="checkbox"/> Not Applicable	Requirement will be met.
C408.2.2.2 [ME54]¹	HVAC hydronic heating and cooling coils have means to balance and have pressure test connections.	<input checked="" type="checkbox"/> Complies <input type="checkbox"/> Does Not <input type="checkbox"/> Not Observable <input type="checkbox"/> Not Applicable	Requirement will be met.
C403.4.2 [ME66]¹	VAV fan motors >= 7.5 hp to be driven by variable speed drive, have a vane axial fan with variable pitch blades, or have controls to limit fan motor demand.	<input type="checkbox"/> Complies <input type="checkbox"/> Does Not <input type="checkbox"/> Not Observable <input checked="" type="checkbox"/> Not Applicable	Exception: Requirement does not apply.

1 High Impact (Tier 1) 2 Medium Impact (Tier 2) 3 Low Impact (Tier 3)

Project Title: Apartment 61B Report date: 06/26/17
Data filename: P:\N10\40300-440_PARK_AVENUE_MEP\CAD\MEP TENANT DESIGN APT 78B\ENG-HVAC\61B- Page 4 of 8
20170522.cck

Section # & Req. ID	Mechanical Rough-In Inspection	Complies?	Comments/Assumptions
C403.4.3.5 [ME26]¹	Reduce flow in pumping systems >10 hp to multiple chillers or boilers when others are shut down.	<input type="checkbox"/> Complies <input type="checkbox"/> Does Not <input type="checkbox"/> Not Observable <input type="checkbox"/> Not Applicable	Requirement will be met.
C403.2.6 [ME57]¹	Exhaust air energy recovery on systems meeting Table C403.2.6	<input type="checkbox"/> Complies <input type="checkbox"/> Does Not <input type="checkbox"/> Not Observable <input type="checkbox"/> Not Applicable	
C403.4.6 [ME31]¹	Condenser heat recovery system that can heat water to 85°F or provide 60% of peak heat rejection is installed for preheating of service hot water.	<input type="checkbox"/> Complies <input type="checkbox"/> Does Not <input type="checkbox"/> Not Observable <input type="checkbox"/> Not Applicable	Requirement will be met.
C403.2.11 [ME71]²	Unenclosed spaces that are heated use only radiant heat.	<input type="checkbox"/> Complies <input type="checkbox"/> Does Not <input type="checkbox"/> Not Observable <input type="checkbox"/> Not Applicable	Exception: Requirement does not apply.

Additional Comments/Assumptions:

1 High Impact (Tier 1) 2 Medium Impact (Tier 2) 3 Low Impact (Tier 3)

Project Title: Apartment 61B Report date: 06/26/17
Data filename: P:\N10\40300-440_PARK_AVENUE_MEP\CAD\MEP TENANT DESIGN APT 78B\ENG-HVAC\61B- Page 5 of 8
20170522.cck

Section # & Req. ID	Final Inspection	Complies?	Comments/Assumptions
C403.2.4.2 [F138]¹	Thermostatic controls have a 5°F deadband.	<input type="checkbox"/> Complies <input type="checkbox"/> Does Not <input type="checkbox"/> Not Observable <input type="checkbox"/> Not Applicable	Requirement will be met.
C403.2.4.2 [F120]¹	Temperature controls have setpoint overlap restrictions.	<input type="checkbox"/> Complies <input type="checkbox"/> Does Not <input type="checkbox"/> Not Observable <input type="checkbox"/> Not Applicable	Requirement will be met.
C403.2.4.3 [F139]¹	Each zone equipped with setback controls using automatic time clock or programmable control system.	<input type="checkbox"/> Complies <input type="checkbox"/> Does Not <input type="checkbox"/> Not Observable <input type="checkbox"/> Not Applicable	Requirement will be met.
C403.2.4.3 [F140]¹	Automatic Controls: Setback to 55°F (heat) and 85°F (cool), 7-day clock, 2-hour occupant override, 10-hour backup.	<input type="checkbox"/> Complies <input type="checkbox"/> Does Not <input type="checkbox"/> Not Observable <input type="checkbox"/> Not Applicable	Requirement will be met.
C408.2.5.1 [F17]¹	Furnished HVAC as-built drawings submitted within 90 days of system acceptance.	<input type="checkbox"/> Complies <input type="checkbox"/> Does Not <input type="checkbox"/> Not Observable <input type="checkbox"/> Not Applicable	
C403.3.3 [F18]¹	Furnished O&M manuals for HVAC systems within 90 days of system acceptance.	<input type="checkbox"/> Complies <input type="checkbox"/> Does Not <input type="checkbox"/> Not Observable <input type="checkbox"/> Not Applicable	
C408.2.5.3 [F143]¹	An air and/or hydronic system balancing report is provided for HVAC systems.	<input type="checkbox"/> Complies <input type="checkbox"/> Does Not <input type="checkbox"/> Not Observable <input type="checkbox"/> Not Applicable	
C408.2.3.2 [F110]¹	HVAC control systems have been tested to ensure proper operation, calibration and adjustment of controls.	<input type="checkbox"/> Complies <input type="checkbox"/> Does Not <input type="checkbox"/> Not Observable <input type="checkbox"/> Not Applicable	
C403.2.2 [F127]¹	HVAC systems and equipment capacity does not exceed calculated loads.	<input type="checkbox"/> Complies <input type="checkbox"/> Does Not <input type="checkbox"/> Not Observable <input type="checkbox"/> Not Applicable	Requirement will be met.
C408.2.1 [F128]¹	Commissioning plan developed by registered design professional or approved agency.	<input type="checkbox"/> Complies <input type="checkbox"/> Does Not <input type="checkbox"/> Not Observable <input type="checkbox"/> Not Applicable	
C408.2.4 [F124]¹	Preliminary commissioning report completed and certified by registered design professional or approved agency.	<input type="checkbox"/> Complies <input type="checkbox"/> Does Not <input type="checkbox"/> Not Observable <input type="checkbox"/> Not Applicable	
C408.2.5.4 [F130]¹	Final commissioning report due to building owner within 90 days of receipt of certificate of occupancy.	<input type="checkbox"/> Complies <input type="checkbox"/> Does Not <input type="checkbox"/> Not Observable <input type="checkbox"/> Not Applicable	
C408.2.3.3 [F131]¹	HVAC equipment has been tested to ensure proper operation.	<input type="checkbox"/> Complies <input type="checkbox"/> Does Not <input type="checkbox"/> Not Observable <input type="checkbox"/> Not Applicable	

1 High Impact (Tier 1) 2 Medium Impact (Tier 2) 3 Low Impact (Tier 3)

Project Title: Apartment 61B Report date: 06/26/17
Data filename: P:\N10\40300-440_PARK_AVENUE_MEP\CAD\MEP TENANT DESIGN APT 78B\ENG-HVAC\61B- Page 6 of 8
20170522.cck

Section # & Req. ID	Final Inspection	Complies?	Comments/Assumptions
C406 [F134]¹	Efficient HVAC performance, efficient lighting system, or on-site supply of renewable energy consistent with what is shown the approved plans.	<input type="checkbox"/> Complies <input type="checkbox"/> Does Not <input type="checkbox"/> Not Observable <input type="checkbox"/> Not Applicable	Requirement will be met.

Additional Comments/Assumptions:

1 High Impact (Tier 1) 2 Medium Impact (Tier 2) 3 Low Impact (Tier 3)

Project Title: Apartment 61B Report date: 06/26/17
Data filename: P:\N10\40300-440_PARK_AVENUE_MEP\CAD\MEP TENANT DESIGN APT 78B\ENG-HVAC\61B- Page 7 of 8
20170522.cck

Section # & Req. ID	Mechanical Rough-In Inspection	Complies?	Comments/Assumptions
C403.2.3 [ME53]¹	HVAC equipment efficiency verified.	<input checked="" type="checkbox"/> Complies <input type="checkbox"/> Does Not <input type="checkbox"/> Not Observable <input type="checkbox"/> Not Applicable	See the Mechanical Systems list for values.
C403.2.5 [ME59]¹	Demand control ventilation provided for spaces >500 sq.ft. and >25 people/1000 sq.ft. occupant density and served by systems with air side economizer, auto modulating outside air damper control, or design airflow >3,000 cfm.	<input type="checkbox"/> Complies <input type="checkbox"/> Does Not <input type="checkbox"/> Not Observable <input type="checkbox"/> Not Applicable	Exception: Requirement does not apply.
C403.2.7 [ME60]¹	HVAC ducts and plenums insulated. Where ducts or plenums are installed in or under a slab, verification may need to occur during Foundation inspection.	<input checked="" type="checkbox"/> Complies <input type="checkbox"/> Does Not <input type="checkbox"/> Not Observable <input type="checkbox"/> Not Applicable	Requirement will be met.
C403.2.8 [ME61]¹	HVAC piping insulation thickness. Where piping is installed in or under a slab, verification may need to occur during Foundation inspection.	<input checked="" type="checkbox"/> Complies <input type="checkbox"/> Does Not <input type="checkbox"/> Not Observable <input type="checkbox"/> Not Applicable	Requirement will be met.
C403.2.8 [ME7]¹	Piping insulation exposed to weather is protected from damage (due to sun, moisture, wind, etc.).	<input checked="" type="checkbox"/> Complies <input type="checkbox"/> Does Not <input type="checkbox"/> Not Observable <input type="checkbox"/> Not Applicable	Requirement will be met.
C403.2.8 [ME41]¹	Thermally ineffective panel surfaces of sensible heating panels have insulation >= R-3.5.	<input checked="" type="checkbox"/> Complies <input type="checkbox"/> Does Not <input type="checkbox"/> Not Observable <input type="checkbox"/> Not Applicable	Requirement will be met.
C403.2.7 [ME10]¹	Ducts and plenums sealed based on static pressure and location.	<input checked="" type="checkbox"/> Complies <input type="checkbox"/> Does Not <input type="checkbox"/> Not Observable <input type="checkbox"/> Not Applicable	Requirement will be met.
C403.2.7.1.3 [ME11]¹	Ductwork operating >3 in. water column requires air leakage testing.	<input type="checkbox"/> Complies <input type="checkbox"/> Does Not <input type="checkbox"/> Not Observable <input checked="" type="checkbox"/> Not Applicable	Exception: Requirement does not apply.
C403.4.3.1 [ME50]¹	Three-pipe hydronic systems using a common return for hot and chilled water are not used.	<input type="checkbox"/> Complies <input type="checkbox"/> Does Not <input type="checkbox"/> Not Observable <input checked="" type="checkbox"/> Not Applicable	Requirement will be met.
C408.2.2.1 [ME53]¹	Air outlets and zone terminal devices have means for air balancing.	<input checked="" type="checkbox"/> Complies <input type="checkbox"/> Does Not <input type="checkbox"/> Not Observable <input type="checkbox"/> Not Applicable	Requirement will be met.
C408.2.2.2 [ME54]¹	HVAC hydronic heating and cooling coils have means to balance and have pressure test connections.	<input checked="" type="checkbox"/> Complies <input type="checkbox"/> Does Not <input type="checkbox"/> Not Observable <input type="checkbox"/> Not Applicable	Requirement will be met.
C403.4.2 [ME66]¹	VAV fan motors >= 7.5 hp to be driven by variable speed drive, have a vane axial fan with variable pitch blades, or have controls to limit fan motor demand.	<input type="checkbox"/> Complies <input type="checkbox"/> Does Not <input type="checkbox"/> Not Observable <input checked="" type="checkbox"/> Not Applicable	Exception: Requirement does not apply.

1 High Impact (Tier 1) 2 Medium Impact (Tier 2) 3 Low Impact (Tier 3)

Project Title: Apartment 61B Report date: 06/26/17
Data filename: P:\N10\40300-440_PARK_AVENUE_MEP\CAD\MEP TENANT DESIGN APT 78B\ENG-HVAC\61B- Page 8 of 8
20170522.cck

06/09/2017 ISSUED FOR DOB
No. _____ Date: _____ Revision: _____
SCALE: NTS

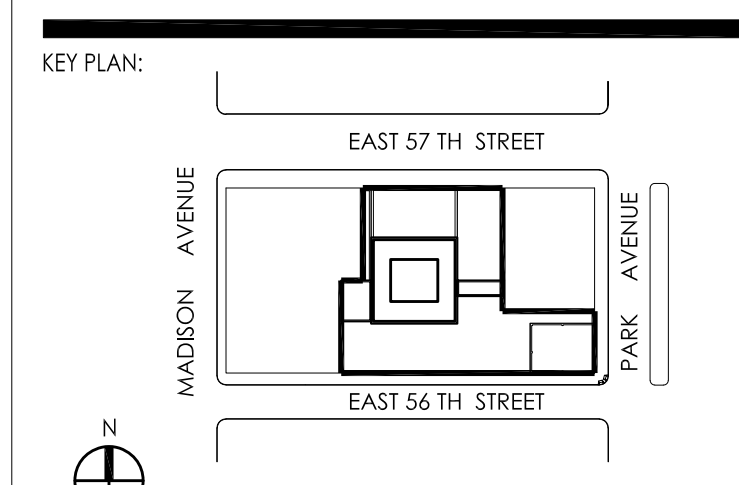

DRAWING TITLE: ENERGY CODE COMPLIANCE SHEET

SEAL & SIGNATURE:	DATE:
	PROJECT No:
	DRAWN BY: DD
	CHECKED BY: DD
	DRAWING No:
	EN-000.00
	CADD FILE No:
	EN-000