

4 ELEVATION  
3/4"=1'-0"

+12'-6"  
HIGH CEILING  
 +11'-1"  
LOW CEILING  
 +10'-1"  
LOW CEILING  
 +9'-0"  
LOW CEILING

+0'-0"  
I.O. FIN FL  
 -0'-2 1/2"  
I.O.S.

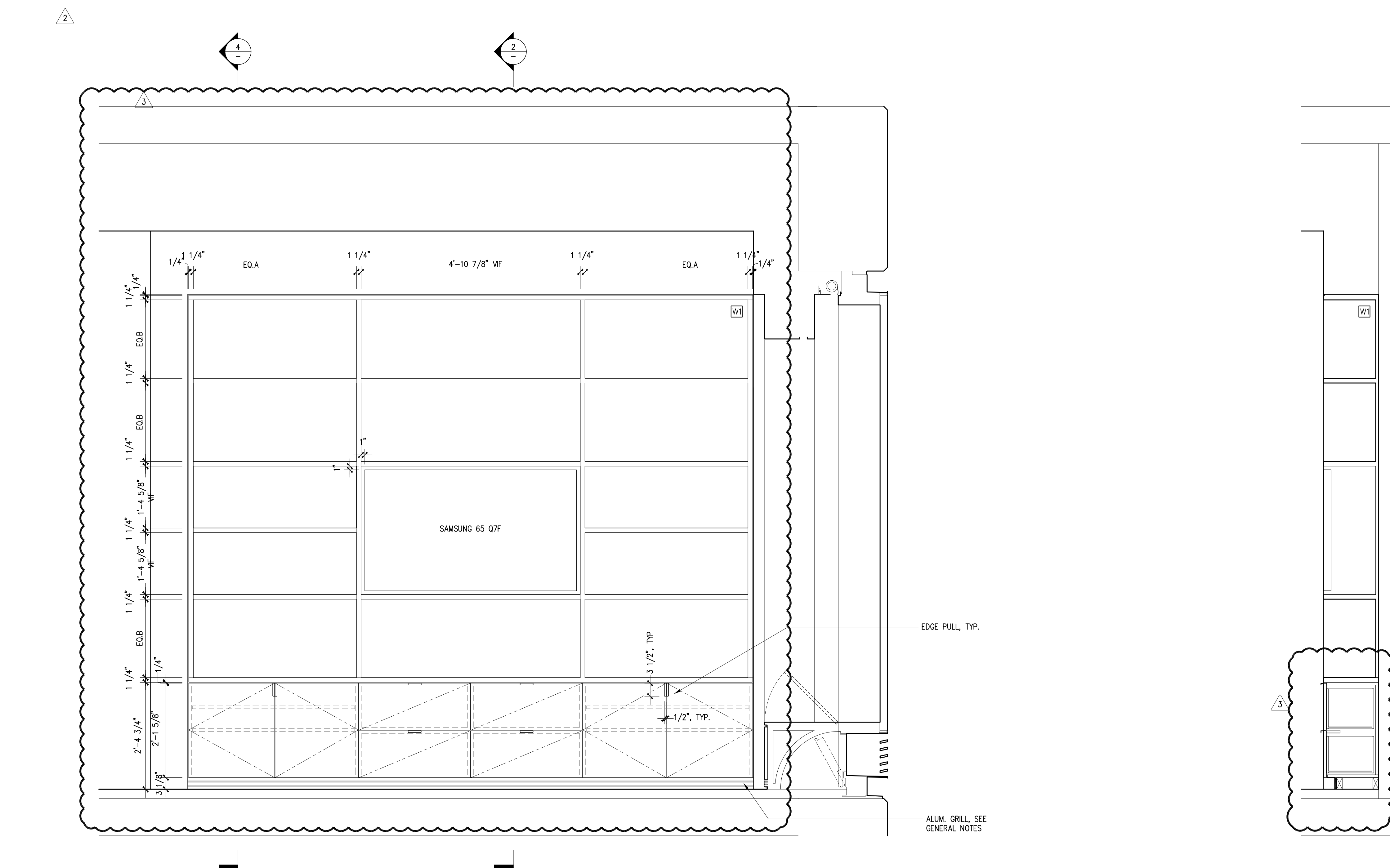

3 ELEVATION  
3/4"=1'-0"

+12'-6"  
HIGH CEILING  
 +11'-1"  
LOW CEILING  
 +10'-1"  
LOW CEILING  
 +9'-0"  
LOW CEILING

+0'-0"  
I.O. FIN FL  
 -0'-2 1/2"  
I.O.S.

2 ELEVATION  
3/4"=1'-0"

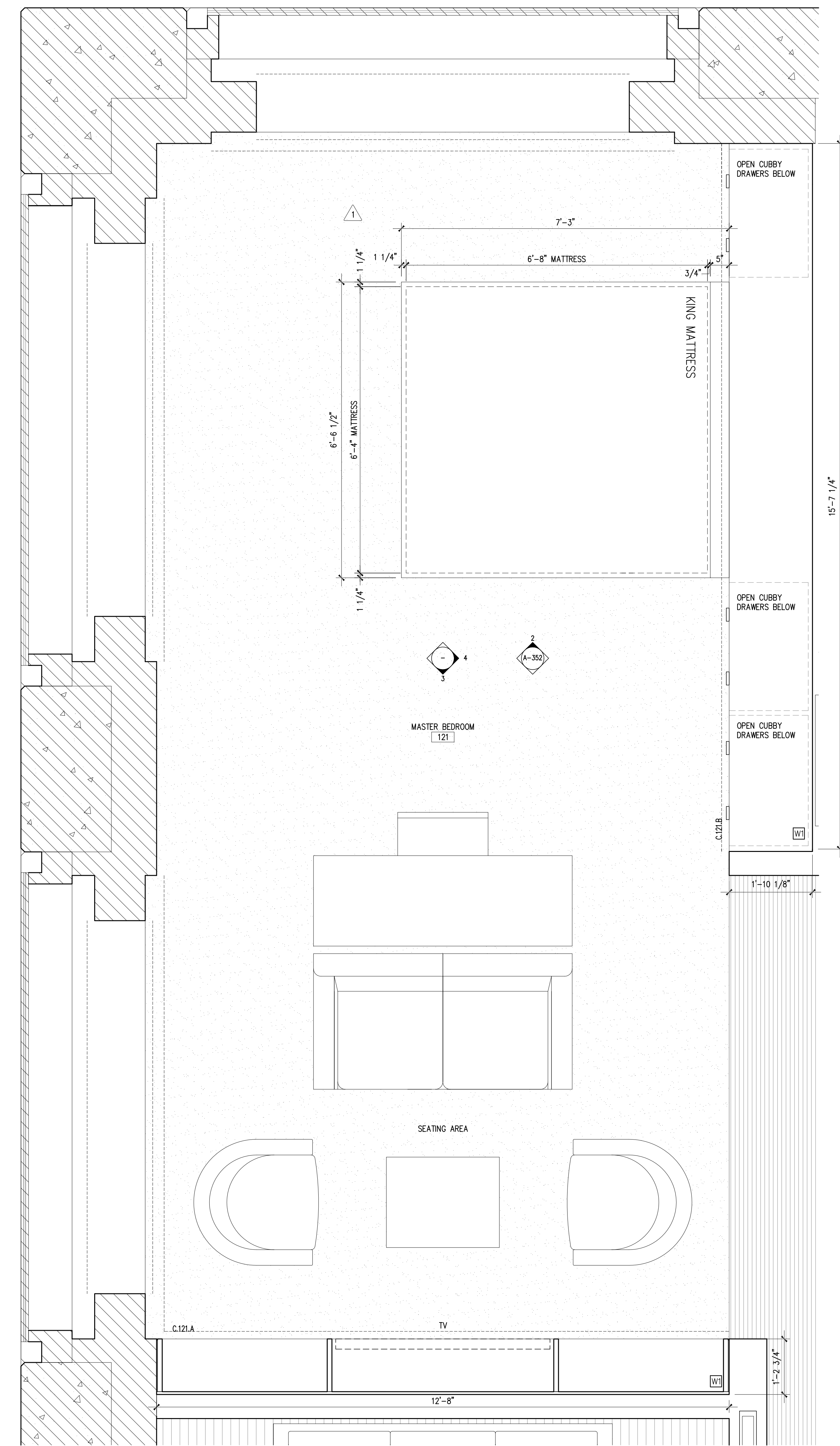

1 DETAIL PLAN  
3/4"=1'-0"

**LEGEND**

W1	SYCAMORE VENEER & EDGING
W2	SYCAMORE VENEER & EDGING
S1	SUPER WHITE STONE
S2	BIANCO NEVE STONE
M1	CLEAR ANODIZED ETCHED ALUMINUM
G1	CLEAR, LOW IRON GLASS
G2	CLEAR, LOW IRON MIRROR
P1	VENETIAN PLASTER

- GENERAL NOTES**
- CABINET PULLS ARE TO BE CUSTOM EDGE PULLS AS SHOWN ON DRAWINGS. ALUMINUM FINISH TO MATCH PROJECT STANDARD.
  - ALUM. GRILLS AT CABINET BASES TO BE 1/8" x 1/8" SPACE CONTINUOUS ANODIZED WITH CONCEALED FASTENING.

No.	Date	Revisions
14	FEB 2018	REVISIONS AS BUBBLED
29	JAN 2018	REVISIONS AS BUBBLED
15	NOV 2017	REVISIONS AS BUBBLED
04	AUG 2017	FOR PRICING

**432 PARK, APT. 78B**  
432 PARK AVENUE, 61ST FLOOR NEW YORK, NY 10022

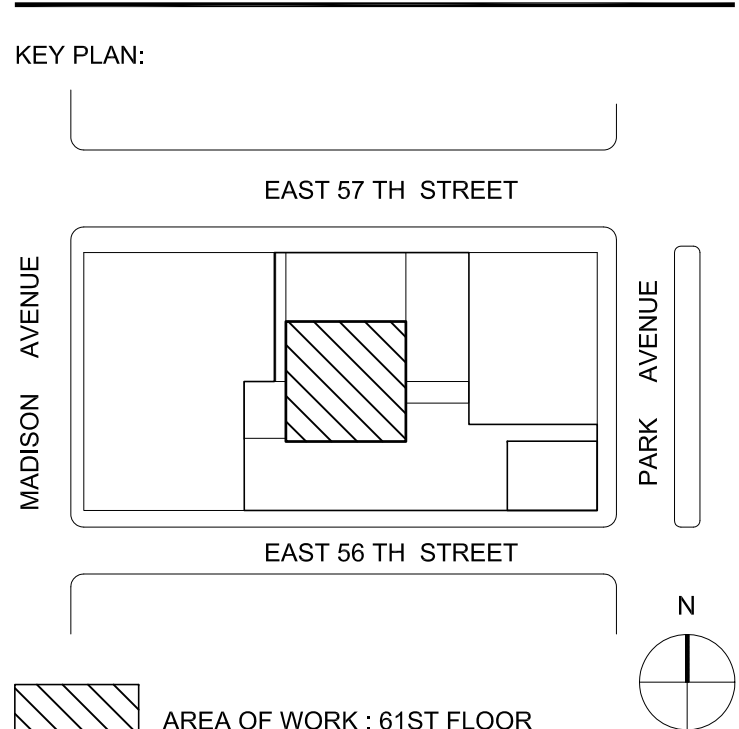

**KANG MODERN**  
ARCHITECTURE + INTERIOR DESIGN

NEW YORK OFFICE  
304 Hudson Street, Suite 500  
New York, NY 10013  
T: 212.462.2028  
F: 212.462.4788

WSP Flack & Kurtz  
312 Seventh Avenue  
New York, NY 10018

M/E/P Engineers  
Tel: (212) 535-9600

HDLC Architectural Lighting design  
10 East 38th Street, 5th Floor  
New York, NY 10016

Lighting Designers  
Tel: (212) 536-7800

18248 SHEETS - SCALE IS FINAL WORKING SCALE  
 18249 SHEETS - SCALE IS 1/2"=1'-0" WORKING SCALE  
 18250 SHEETS - SCALE IS 1/2"=1'-0" WORKING SCALE  
 18251 SHEETS - INTS