

**LEGEND**

- SY SYCAMORE VENEER & EDGING
- SW SUPER WHITE STONE
- BN BIANCO NEVE STONE
- EA CLEAR ANODIZED ETCHED ALUMINUM
- GL CLEAR, LOW IRON GLASS
- MR CLEAR, LOW IRON MIRROR
- VP VENETIAN PLASTER

**GENERAL NOTES**

1. UNLESS OTHERWISE NOTED, THE SPECIFICATION FOR SURFACE MOUNTED CABINET PULLS ARE TO BE DETERMINED.
2. ALUM. GRILLS AT CABINET BASES TO BE 1/8" x 1/8" SPACE CONTINUOUS ANODIZED WITH CONCEALED FASTENING.

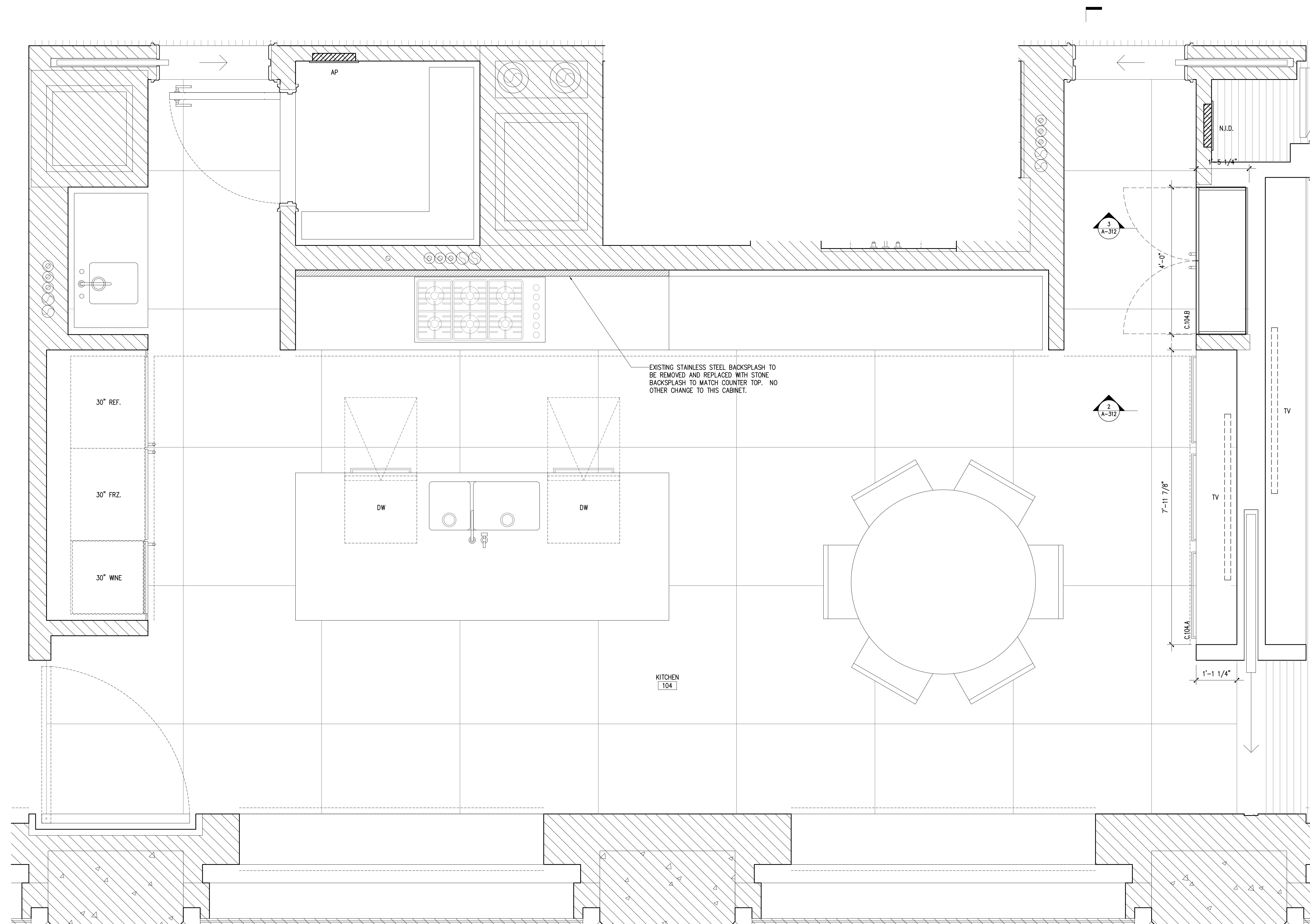

**1 DETAIL PLAN**  
3/4"=1'-0"

04 AUG 2017 FOR PRICING

No. Date Issues/Revisions

**432 PARK AVENUE, 61ST FLOOR** NEW YORK, NY 10022

KEY PLAN:

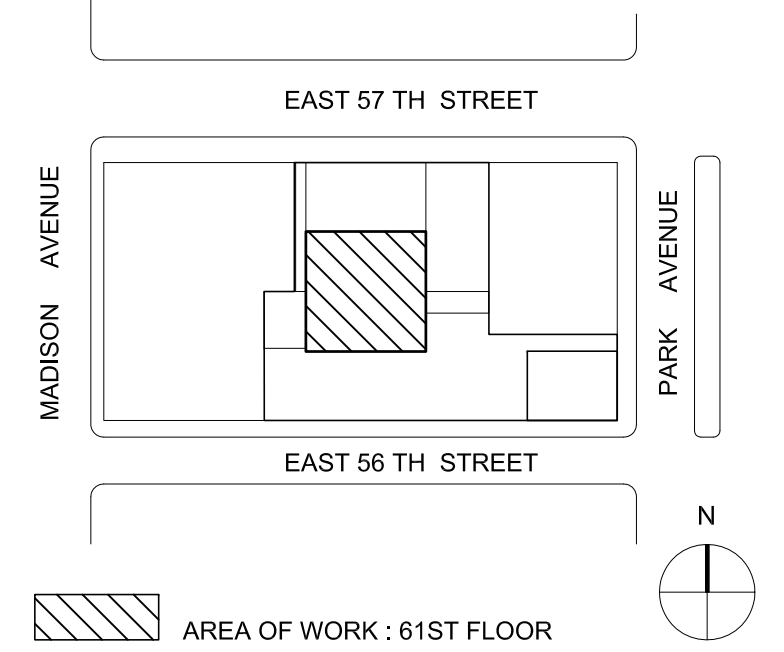

**KANG MODERN**

architects + interior designers  
NEW YORK OFFICE  
304 Hudson Street, Suite 500  
New York, NY 10013

T 212.462.2028  
F 212.462.4788

WSP Flack & Kurtz  
312 Seventh Avenue  
New York, NY 10018

ME/P Engineers  
Tel: (212) 535-9600

HDLC Architectural Lighting design  
10 East 28th Street, 5th Floor  
New York, NY 10016

Lighting Designers  
Tel: (212) 536-7800

**KITCHEN PLAN**

Scale: 3/4"=1'-0"  
Date: 25 JAN 2017

**A-311**